

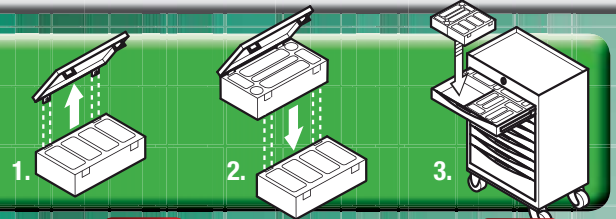

# PRICES ON SETS & KITS

QUALITY, DURABILITY SWEDISH DESIGN... ALL THE TOOLS YOU NEED

**BUILD YOUR OWN KIT**



**35 PCE 1/4" DR METRIC SOCKET SET**

Part No. TT1435

- Deep: 6-13mm Reg: 4-13mm, bits: TPX, HEX, PH, PZ, Flat



**32 PCE 1/4" & 3/8" DR SOCKET SET**

Part No. TTAF32

- Regular & deep AF 6 point sockets 3/16"-3/4"



**35 PCE 1/4" & 3/8" DR BITS SOCKET SET**

Part No. TTBS35

- HEX, TX, PH, PZ & Flat type, 2 adaptor drive.



**19 PCE 3/8" DR METRIC SOCKET SET**

Part No. TT3819

- 8-22mm, uni joint, extension bar 75mm, 10" rotating spinner handle.



**5 PCE 1/2" DR SOCKET ACCESSORY SET**

Part No. TT1205

- 1/2" dr ratchet 5" & 10" extensions, 3/8"F:1/2" M T bar adaptor.



**17 PCE 1/2" DR METRIC SOCKET SET**

Part No. TT1217

- 10-32mm socket set, 12 point



**15 PCE 1/2" DR AF SOCKET SET**

Part No. TT1215AF

- 3/8"-1 1/4" socket set, 12 point



**17 PCE 1/2" DR METRIC SOCKET SET**

Part No. TT1218

- 10-24mm socket set, 12 point, 2 1/2" & 6" extensions, 3/8"F:1/2" M T bar adaptor.



**11 PCE 1/2" DR DEEP METRIC SOCKET SET**

Part No. TT1211

- 10-19mm socket set, 10" flex handle



**15 PCE HEX IMPACT SOCKET BIT SET**

Part No. TT9015HX

- 3/8" dr: 4-12mm & 1/2" dr: 5-17mm



**8 PCE AF RATCHETING COMBINATION SPANNER SET**

Part No. TT6508RAF

- 15/16, 3/8", 7/16", 1/2", 9/16", 5/8", 11/16", 3/4", 150 offset.



**8 PCE METRIC FLAT RATCHETING COMBINATION SPANNER SET**

Part No. TT6508RS

- Sizes: 8-19mm, chrome vanadium satin finish



**4 PCE MEGA BITE PLIER SET**

Part No. TT440

- 10" water pump, 6" side cutter, 7" combination and 8" long nose pliers.



**4 PCE 7" CIRCLIP PLIER SET**

Part No. TT474-7

- 2 straight & 2 bent tip. For external & internal circlips, fitted with return spring.



**5 PCE SELF-LOCKING PLIER SET**

Part No. TTVG05

- Self-locking pliers with release lever. 3 with serrated, adjustable jaws with pipe grip & cutters, 2 long nose



**7 PCE SCREWDRIVER SET**

Part No. TT917

- TT-MV steel blade, Flat, PH and PZ drive heads.



**7 PCE TX SCREWDRIVERS**

Part No. TT917TX

- 2 TX and 5 TPX, TT-MV steel blade, for internal TX heads.



**74 PCE 1/4" RATCHETING BIT DRIVER**

Part No. TTMD74

- 4" & 6" extension, adaptor, coupler adaptor & bits, Flat, PH, PZ, HEX, TX, TPX & SQ .



**16 PCE MINI PLIER & TORX SCREWDRIVER SET**

Part No. TTMI16

- 12 mini screwdrivers and 4 mini pliers.



**5 PCE MEASURING KIT**

Part No. TTCM05D

- Digital vernier caliper, micrometer, precision square, rule & scriber

# YOUR ACCOUNTANT WILL LIKE

WHAT YOU NEED... ALL GUARANTEED



**\$45**

## CUTTING EDGE SET

Part No. 700-PRO5

- Utility knife, junior hacksaw & 12" hacksaw.

**\$2.90**



## SNAP OFF BLADE & KNIFE

Part No. 710C

- Including brake off tool and pocket clip

**\$17.50**



## FOLDING UTILITY KNIFE

Part No. 712

- Locking blade, auto loading, with 3 blades

**\$17.50**



## 28 PCE BITS SET

Part No. TM028

- 1/4" hex drive, 50mm quick release bit holder adaptor
- 1/4" square to 1/4" hex • Bits, Flat, Phillips, Torx, Tamper Proof Torx, ROB, Hex, Grabber no2 (2 pce).

**\$125**

**STAINLESS**



## 3 PCE 4430

## STAINLESS STEEL SOCKET SET

Part No. MS1203

- 1/2" dr 6 point deep stainless metric sockets supplied on a clip rail • Deep sockets 17, 19 and 21mm

## EUROPEAN DESIGN

- New steel alloy with CrMo gives better cutting capacity
- Fully grinded heads for better outlook
- New design on the bi-material handles.



## 8" HEAVY DUTY SIDE CUTTER

Part No. MB442-8T

**\$25**



**\$45**

## 10" HEAVY DUTY CABLE CUTTER

Part No. MB445-10

- Made of chrome molybdenum steel. For copper & aluminium electric cables. One hand function with pitch guard. Cuts copper cable 60mm

## RAIL SOCKET BIT SETS

### 3/8" DRIVE



**\$45**

## TAMPER PROOF TORX BIT

Part No. M3813TPX

- 9 pce sizes: TPX10-TPX50



**\$39**

## AF HEX BIT

Part No. M3811

- 8 pce sizes: 3/32"-3/8"



**\$39**

## METRIC HEX BIT

Part No. M3812

- 9 pce sizes: 3-12mm



**\$45**

## TORX BIT

Part No. M3813TX

- 9 pce sizes: TX10-TX50

### 1/2" DRIVE



**\$45**

## DR TORX-E SET

Part No. M1210

- 9 pce sizes: E10-E24



**\$39**

## LONG METRIC HEX BIT

Part No. M1211

- Sizes: 1/2" Dr: 5-12mm, 100mm long



**\$49**

## HEX METRIC SET

Part No. M1212

- 9 pce sizes: 5mm-17mm



**\$49**

## TAMPER PROOF TORX BITS

Part No. M1213TPX

- 9 pce sizes: TPX20-TPX60.

### 1/4 & 3/8" DRIVE

## TORX-E SOCKET SET

Part No. M3814

- Sizes: 1/4" Dr: E4-E8 • Sizes: 3/8" Dr: E10-E18



**\$33**

## 34 PIECE DRILL BIT SET

Part No. DB034

- Spiral angle 28°, Split point 118°.
- High speed steel ground from solid
- Contains: 1.0 x 4, 1.5 x 3, 2.0 x 2, 1 of each 2.5 to 13.0mm.

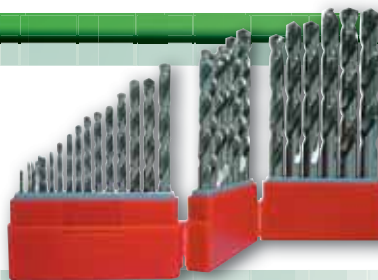

**\$125**

## LUNA WRENCHES, MAKE A REAL

### 3/4" DRIVE IMPACT WRENCH



**\$549**



**1560NM 1165FT/LBS MAXTORQUE**  
Part No. 205690100

- High torque action twin hammer
- Stepless trigger • Ergonomic insulated soft grip handle keeps out cold & vibration
- 360° swivelling air inlet • Magnesium alloy body
- 3 forward torque settings: 1080/1390/1560Nm (805/1040/1165ftlbs) • Reversible action
- Handle exhaust (89.6db) with facility to fit an air drain.

### 1/2" DRIVE COMPOSITE IMPACT WRENCH



**\$339**



**720NM 540FT/LBS MAX TORQUE**  
Part No. 207340209

- High torque twin hammer mechanism
- Stepless trigger • Ergonomic insulated soft grip handle keeps out cold & vibration
- 360° swivelling air inlet • 3 forward torque settings 490/585/690Nm (366/437/515ft/lbs)
- Reversible action • Handle exhaust (>85.8db) with facility to fit an air drain

### 1/2" DRIVE MINI COMPOSITE IMPACT WRENCH

**LIGHT  
WEIGHT**



**\$285**



**475NM 355FT/LBS MAX TORQUE**  
Part No. 207340100

- High torque twin hammer mechanism
- Stepless trigger • Ergonomic insulated soft grip handle keeps out cold & vibration
- Lightweight composite housing
- 360° swivelling air inlet • 3 forward torque settings 280/370/475Nm (209/276/355ft/lbs)
- Reversible action • Handle exhaust



**WITH  
QUICK  
CHUCK**

**\$269**



**AIR DRILL MACHINE & DRILL SET**  
SPEED: 1800RPM DRILL CAPACITY: 10MM  
Part No. 208060202

- Suitable for maintenance & service work
- Ergonomically designed handle • 360° Swivel air intake • With support handle
- Supplied in a plastic case with drill set of 24 drills • Drill sizes: 1-10mm
- 1 air lubricator, centre punch and support handle.



**\$249**



**3/8" DRIVE AIR RATCHET**  
SPEED: 240RPM  
Part No. 205730104

- Supplied with 17 impact sockets standard 8-19mm
- Deep 10-19mm, 2 extensions 125mm & 75mm
- Universal joint, socket adaptor
- Oil mist lubricator & 10ml pneumatic tool oil.

# T, SAND IT, DRILL IT!

THE TOOLS YOU NEED... ALL GUARANTEED

## REAL IMPACT!

### 3/8" DRIVE MINI COMPOSITE IMPACT WRENCH

LIGHT WEIGHT



\$249



#### 445NM 332FT/LBS MAX TORQUE

Part No. 150440105

- High torque twin hammer mechanism
- Stepless trigger • Ergonomic insulated soft grip handle keeps out cold & vibration
- Lightweight composite housing
- 360° swivelling air inlet • 3 forward torque settings 250/310/445Nm (186/231/332ft/lbs)
- Reversible action • Handle exhaust



\$369



#### 5" AIR ANGLE GRINDER SPEED: 10,000RPM

Part No. 207770207

- Ergonomically designed handle which insulates against vibrations. Air discharge through the handle
- Safety throttle. 360° swivel hose connection
- adjustable in 9 different positions
- Side handle with vibration damping.

#### MINI DIE GRINDER



\$139



#### MINI DIE GRINDER

Part No. 207370107

- Speed 25,000RPM • Length 160mm • For shaft diameter 3 & 6mm plus 1/4"
- Equipped with rear exhaust & safety lever to prevent undesired start
- 360° swivelling air intake.

90°



\$149



#### 90° DIE GRINDER

Part No. 207380106

- Speed 22,000RPM • Length 165mm
- For shank diameter 3 & 6mm plus 1/4"
- Equipped with rear exhaust & safety lever to prevent undesired start • 360° swivelling air intake.



\$145



#### AIR NIBBLER

Part No. 207350109

- Capacity: 1.6mm mild steel
- Speed: 3,500 per min
- Minimum radius: 4.5mm
- Air inlet size: 1/4" NPT



\$149



#### 3" CUT OFF TOOL SPEED: 20,000RPM

Part No. 207780107

- Safety trigger with swivelling air inlet
- Equipped with disc guard.



FROM \$135



#### PENCIL DIE GRINDERS

Part No. 207400102 54,000RPM \$135

Part No. 207400201 70,000RPM \$155

- High speed • For shaft diameter 3mm
- 360° swivelling air intake.



\$139



#### 1/2" DRIVE AIR RATCHET

Part No. 205720204

- Free Speed 240RPM • Length: 330mm
- Weight: 1.35kg • Reversible. 360° swivel air intake
- Insulated ergonomic grip.



\$275



#### ORBITAL SANDER SPEED: 12,000RPM

Part No. 207490202

- Back-up pad diam: 150mm • Spindle thread female: 5/16 x 24 UNF • Eccentric motion: 5mm
- Sound level (EN ISO 15744): 82db
- Vibration (ISO 8662-8)m/s<sup>2</sup>: 2.4
- Rec. hose dimension: 3/8
- Connection thread: 1/4
- Rear exhaust air flow with muffler
- 360° swivel hose connection.